

Bermondsey
Project

Client
Southwark GP Nominee 1 Ltd. and
Southwark GP Nominee 2 Ltd.

KPF
Kohn Pedersen Fox Associates
(International) PA
Architects and Planning Consultants

7a Langley Street, London WC2H 9JA
T: +44 (0) 20 3119 5300
<http://www.kpf.com>

Structural Engineer
WSP - Tel: 207 337 1700

MEP Engineer
Hilson Moran - Tel: 207 940 8888

Landscape Consultant (Strategy)
Arup - Tel: 207 636 1531

Landscape Consultant (Design)
Andy Sturgeon - Tel: 127 367 2575

Structural Engineer (Building F)
AKT II - Tel: 207 250 7777

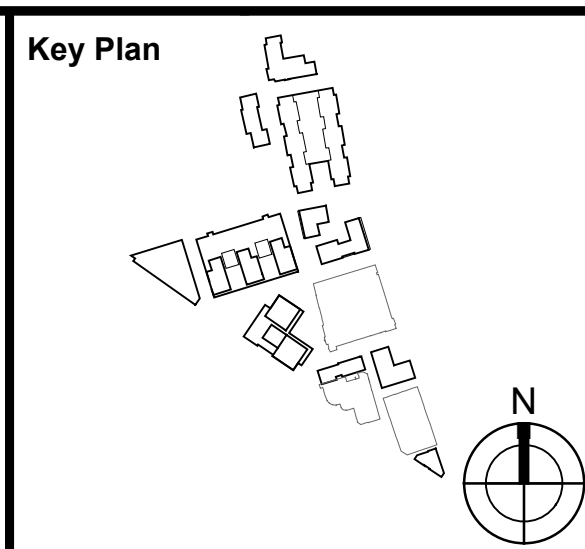

Notes

 OUTLINE COMPONENT

0 12.5M 25M 50M

SCALE: 1:500

A	AMENDED PROPOSALS	16.09.19
---	-------------------	----------

Sheet No.	Project		
2607	Bermondsey Project		
Scale	Drawn by	Checked by	
1:500 @ A0			
Drawing Title and No.			
LEVEL 01 FLOOR PLAN			
EXISTING			
Drawing Ref.	Rev.		
2607-KPF-MPLN-01-DR-PLN-			
A-0071			A